

**This electronic collection of documents is provided  
for the convenience of the user  
and is Not a Certified Document –**

**The documents contained herein were originally issued  
and sealed by the individuals whose names and license  
numbers appear on each page, on the dates appearing  
with their signature on that page.**

**This file or an individual page  
shall not be considered a certified document.**

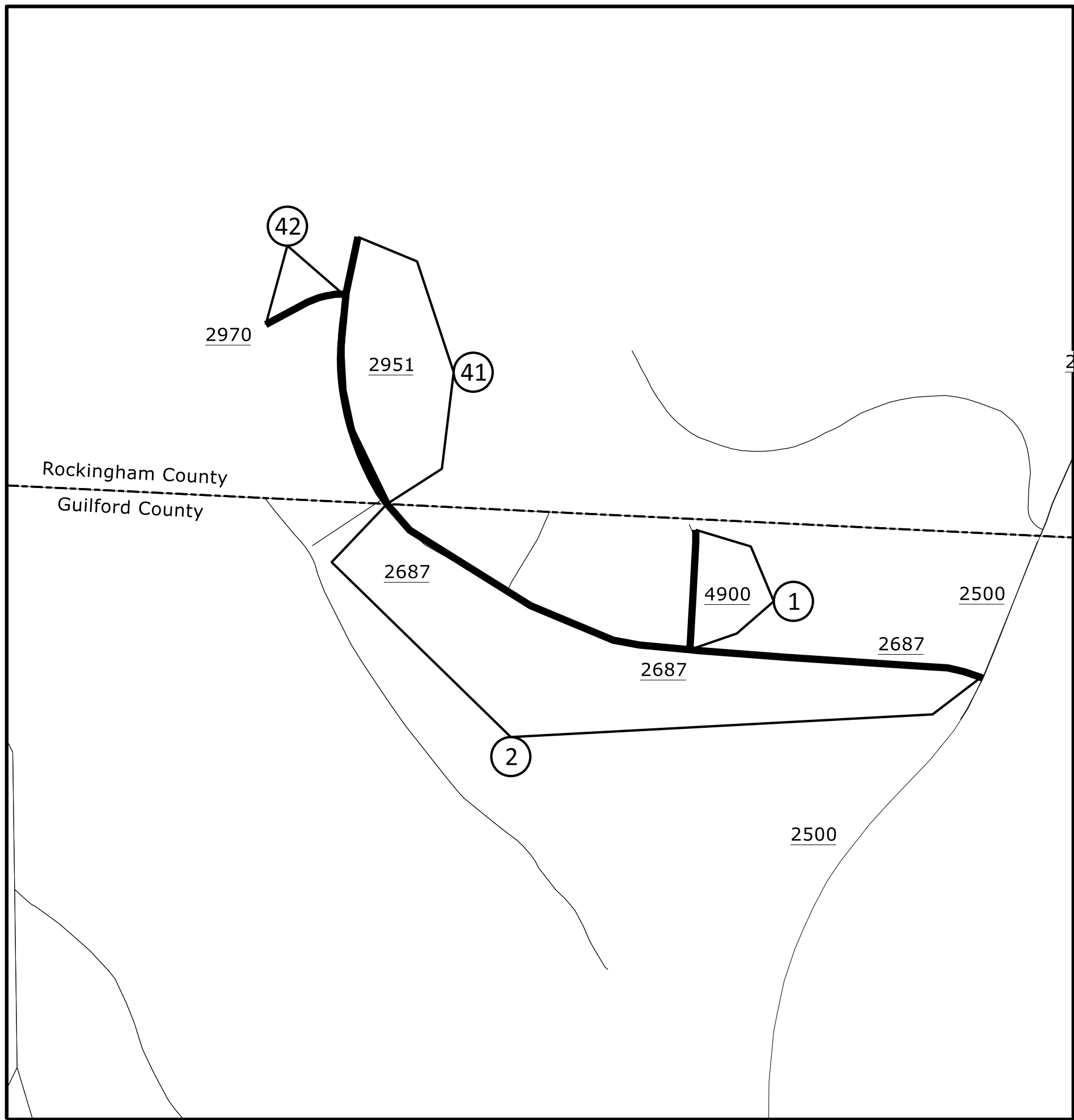

- Map 1 SR 4900 - Fox Crossing Rd
- Map 2 SR 2687 - River Run Rd
- Map 41 SR 2951 - River Run Rd  
(ROCKINGHAM COUNTY)  
2024CPT.07.04.20791
- Map 42 SR 2970 - Ravens Bluff Ct  
(ROCKINGHAM COUNTY)  
2024CPT.07.04.20791

**GUILFORD COUNTY**  
**ROCKINGHAM COUNTY**  
NORTH CAROLINA

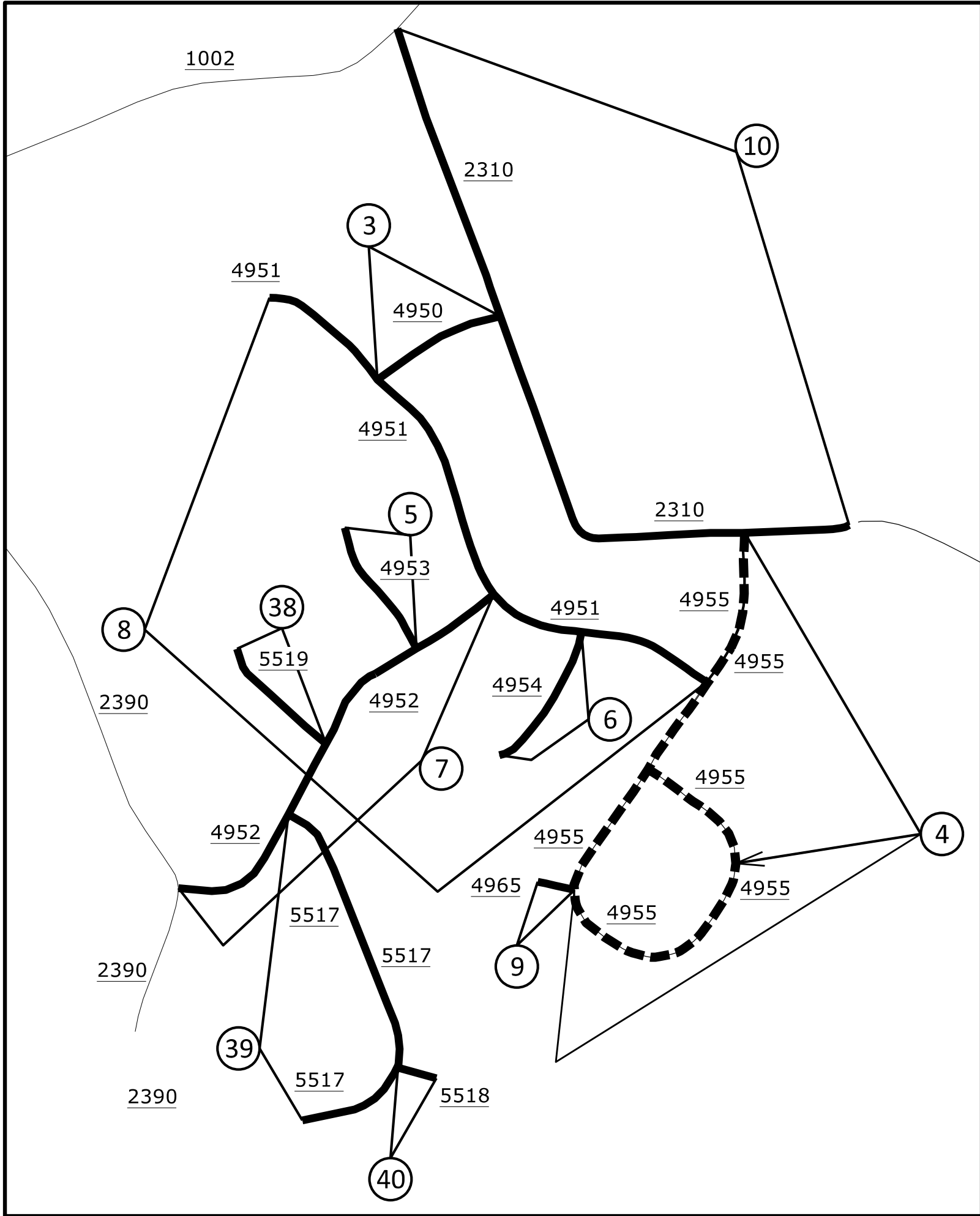

- Map 3 SR 4950 - Lennox Woods Dr
- Map 4 SR 4955 - Bethan Dr
- Map 5 SR 4953 - Ipswich Ct
- Map 6 SR 4954 - Kintail Ct
  
- Map 7 SR 4952 - Loch Lomond Dr  
Only put 78M Seal at Approximate 550 ft section at beginning of Map near SR 4951 William Wallace Dr.  
Overlay entire map with 1 1/2" S9.5B
  
- Map 38 SR 5519 - Caithness Court
- Map 39 SR 5517 - Rob Roy Drive  
Overlay entire map with 1 1/2" S9.5B  
NO Seal Coat
  
- Map 40 SR 5518 - Rob Roy Court
- Map 8 SR 4951 - William Wallace Dr
- Map 9 SR 4965 - Royal Stewart Ct
- Map 10 SR 2310 - Cummings Dairy Rd

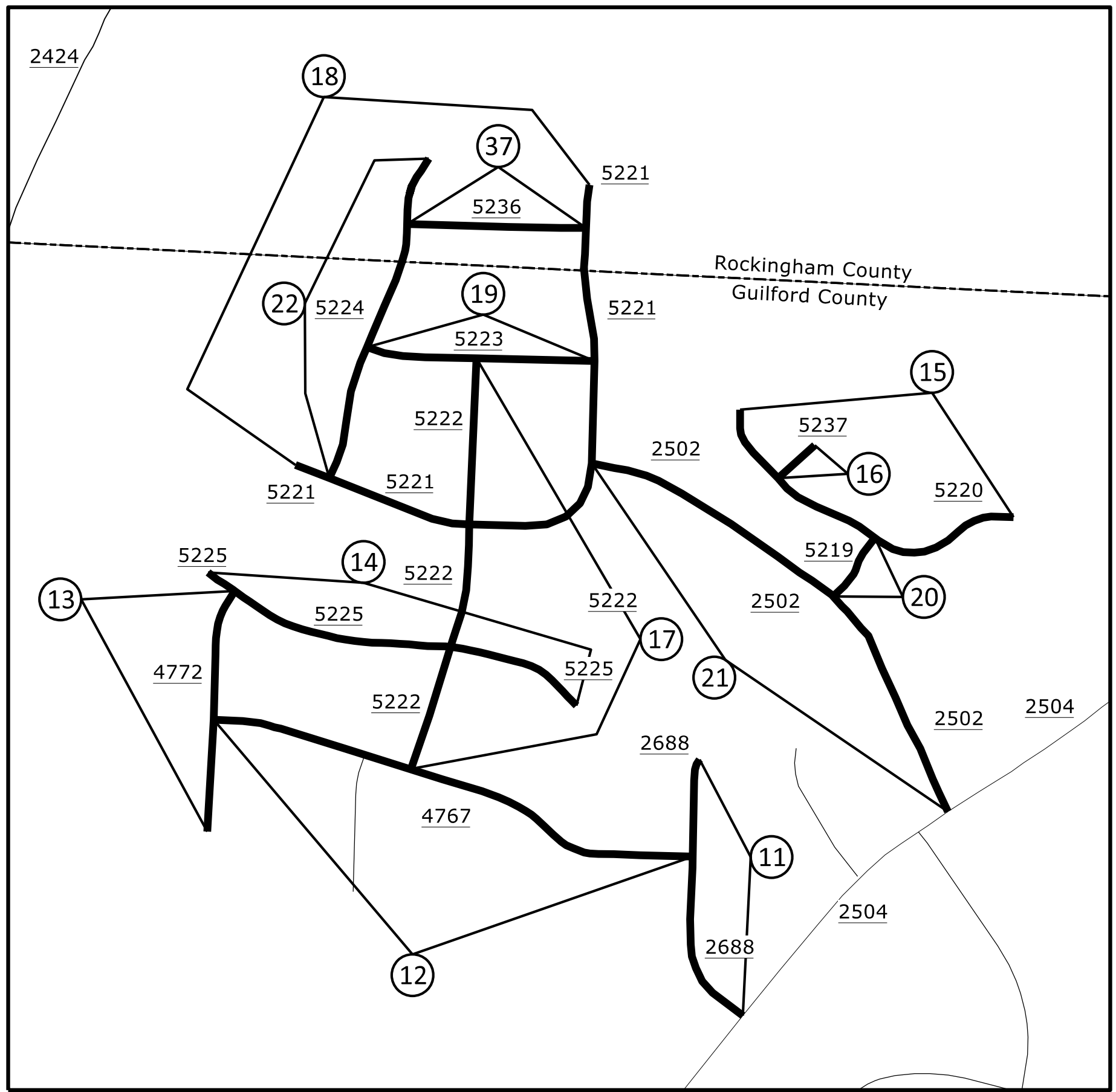

- Map 11 SR 2688 - Spencers Grove Rd
- Map 12 SR 4767 - Mitchell Wood Dr
- Map 13 SR 4772 - Busickwood Dr
- Map 14 SR 5225 - Walbrook Tr
- Map 15 SR 5220 - Garrick Trc
- Map 16 SR 5237 - Exmoor Trc
- Map 17 SR 5222 - Dorwood Dr
  
- Map 18 SR 5221 - Cripplegate Trl  
(GUILFORD AND ROCKINGHAM COUNTY)  
Charge this map to 2024CPT.07.04.20411
  
- Map 19 SR 5223 - Aldgate Way
- Map 20 SR 5219 - Burfield Pl
- Map 21 SR 2502 - Bevill Oaks Rd
  
- Map 22 SR 5224 - Newgate Trc  
(GUILFORD AND ROCKINGHAM COUNTY)  
Charge this map to 2024CPT.07.04.20411
  
- Map 37 SR 5236 - Bishopsgate Way  
(ROCKINGHAM COUNTY)  
Charge this map to 2024CPT.07.04.20411

**GUILFORD COUNTY**  
**ROCKINGHAM COUNTY**  
NORTH CAROLINA

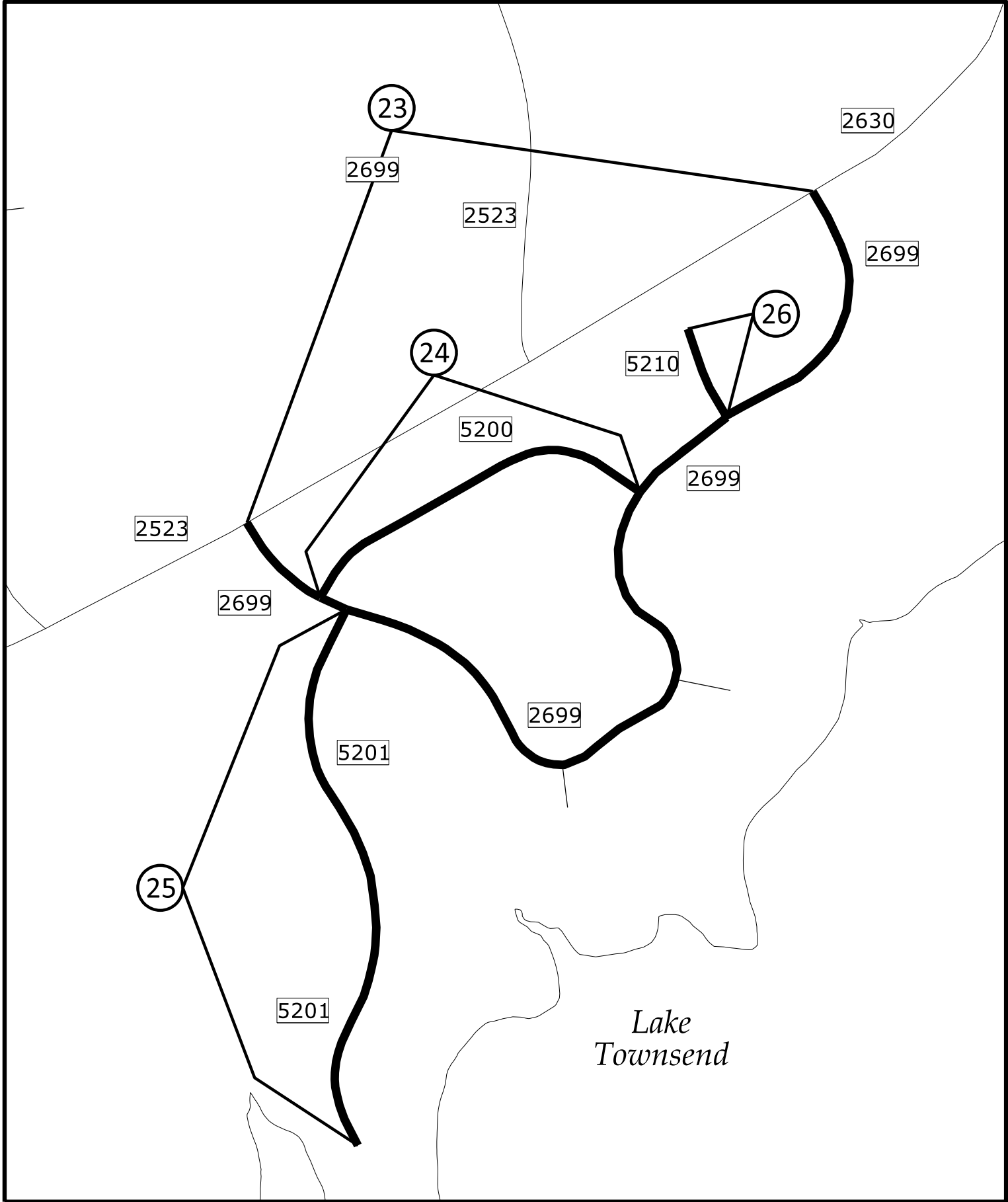

- Map 23 SR 2699 - Northbay Dr
- Map 24 SR 5200 - Wicklow Dr
- Map 25 SR 5201 - Lismore Dr
- Map 26 SR 5210 - Bantry Ct

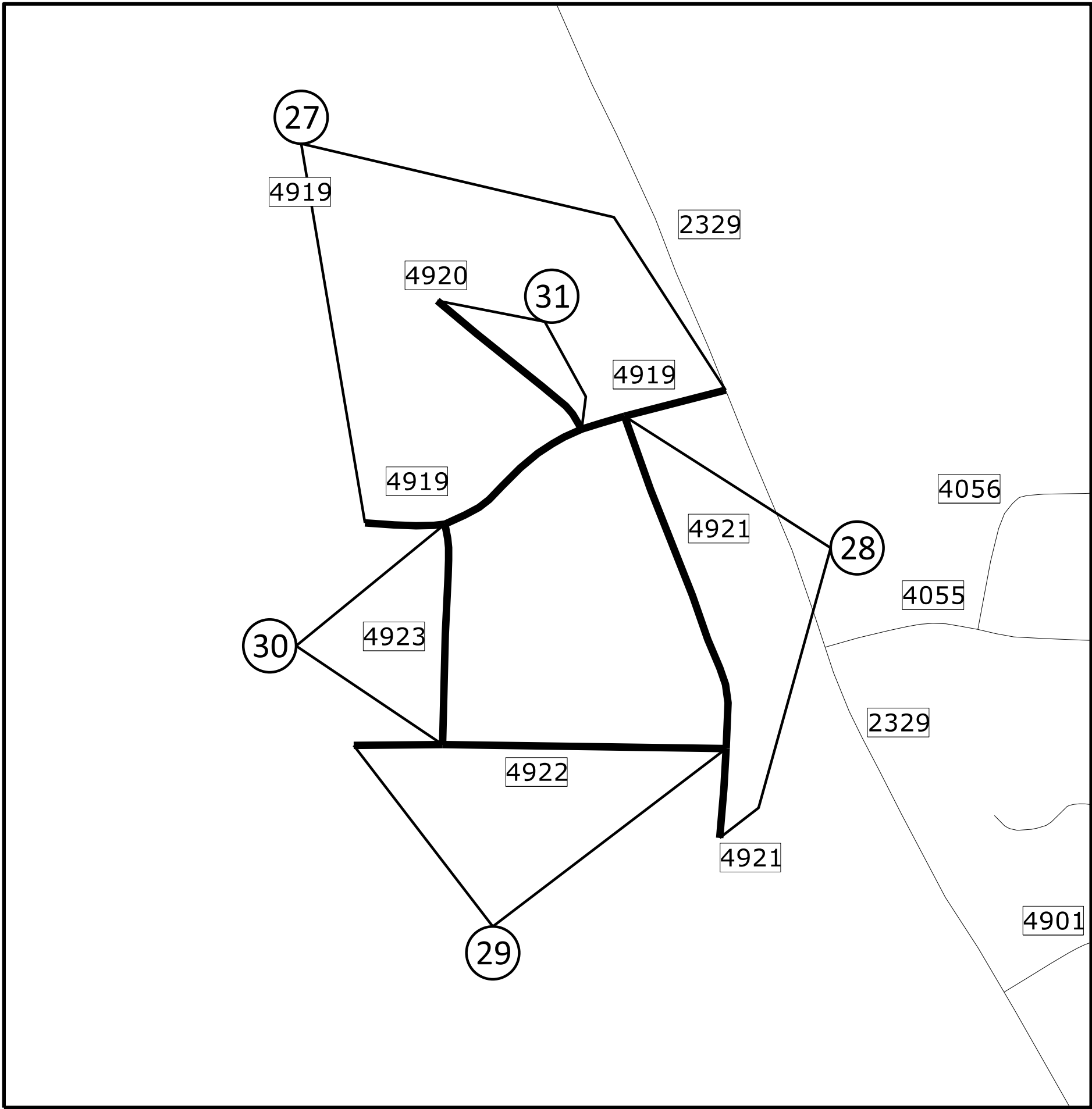

- Map 27 SR 4919 - James Doak Pkwy
- Map 28 SR 4921 - Clopton Dr
- Map 29 SR 4922 - Fosseway Dr
- Map 30 SR 4923 - Brixham Dr
- Map 31 SR 4920 - Colwyn Ct

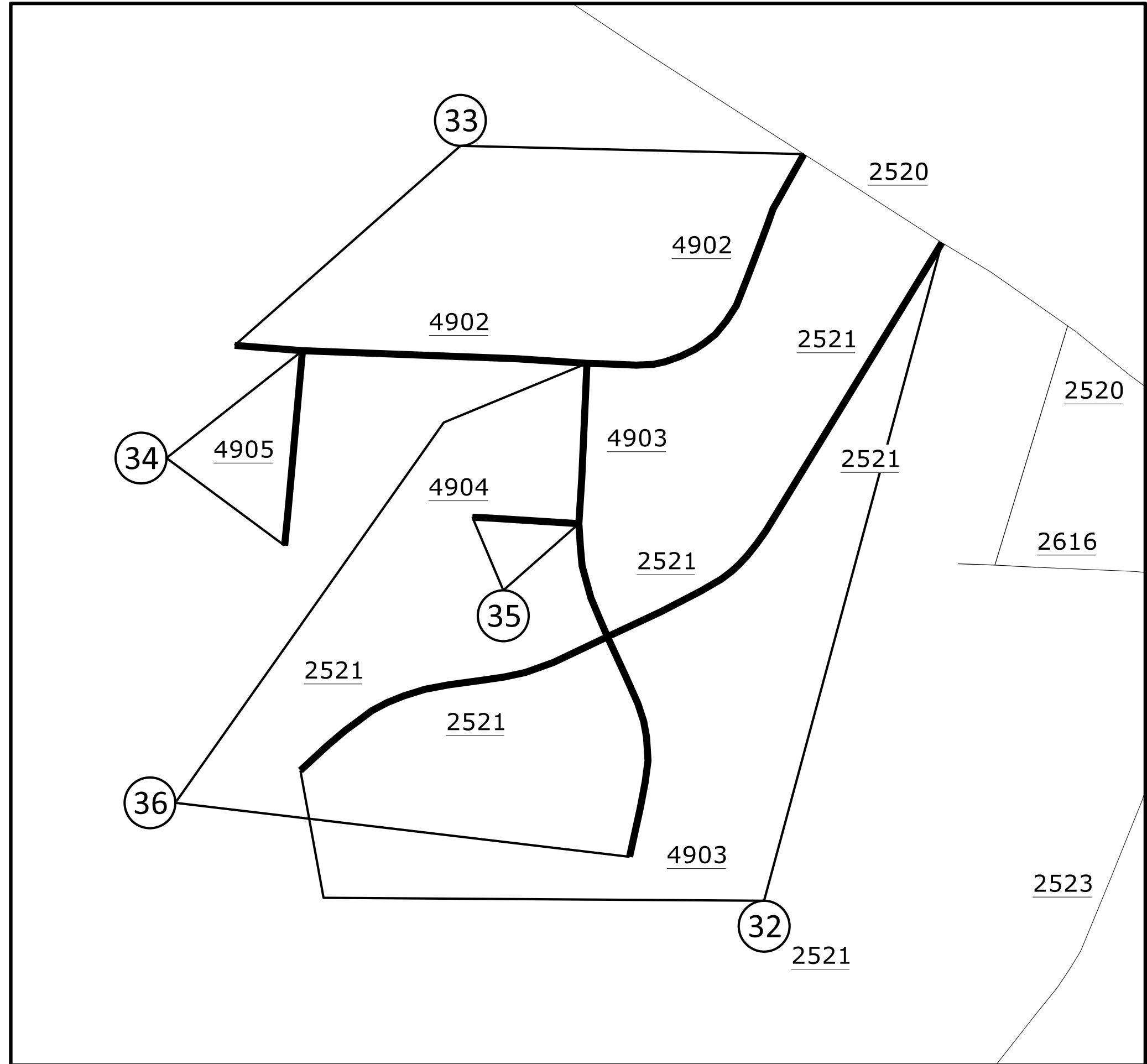

- Map 32 SR 2521 - Fairhaven Rd
- Map 33 SR 4902 - Foxhaven Dr
- Map 34 SR 4905 - Foxhaven Ct
- Map 35 SR 4904 - Tally Ho Ct
- Map 36 SR 4903 - Foxdale Dr

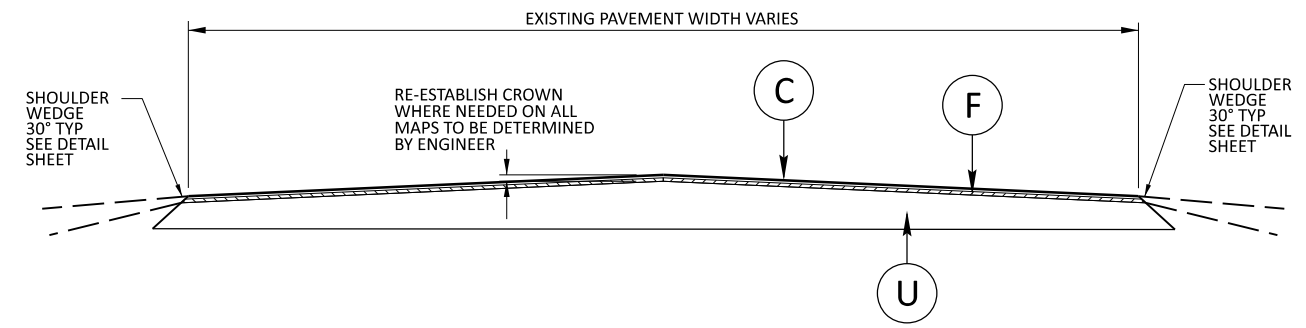

**TYPICAL SECTION NO. 1**

Map 1	SR 4900 - Fox Crossing Rd	Map 21	SR 2502 - Bevill Oaks Rd
Map 2	SR 2687 - River Run Rd	* Map 22	SR 5224 - Newgate Trc
Map 3	SR 4950 - Lennox Woods Dr	Map 23	SR 2699 - Northbay Dr
Map 4	SR 4955 - Bethan Dr	Map 24	SR 5200 - Wicklow Dr
Map 5	SR 4953 - Ipswich Ct	Map 25	SR 5201 - Lismore Dr
Map 6	SR 4954 - Kintail Ct	Map 26	SR 5210 - Bantry Ct
Map 7	SR 4952 - Loch Lomond Dr Only put 78M Seal at the Approximate 550 ft section at beginning of Map near SR 4951 William Wallace Dr. Overlay entire map with 1 ½" S9.5B	Map 27	SR 4919 - James Doak Pkwy
Map 8	SR 4951 - William Wallace Dr	Map 28	SR 4921 - Clopton Dr
Map 9	SR 4965 - Royal Stewart Ct	Map 29	SR 4922 - Fosseyway Dr
Map 10	SR 2310 - Cummings Dairy Rd	Map 30	SR 4923 - Brixham Dr
Map 11	SR 2688 - Spencers Grove Rd	Map 31	SR 4920 - Colwyn Ct
Map 12	SR 4767 - Mitchell Wood Dr	Map 32	SR 2521 - Fairhaven Rd
Map 13	SR 4772 - Busickwood Dr	Map 33	SR 4902 - Foxhaven Dr
Map 14	SR 5225 - Walbrook Tr	Map 34	SR 4905 - Foxhaven Ct
Map 15	SR 5220 - Garrick Trc	Map 35	SR 4904 - Tally Ho Ct
Map 16	SR 5237 - Exmoor Trc	Map 36	SR 4903 - Foxdale Dr
Map 17	SR 5222 - Dorwood Dr	* Map 37	SR 5236 - Bishopsgate Way
* Map 18	SR 5221 - Cripplegate Trl	Map 38	SR 5519 - Caithness Court
Map 19	SR 5223 - Aldgate Way	Map 40	SR 5518 - Rob Roy Ct
Map 20	SR 5219 - Burfield Pl	** Map 41	SR 2951 - River Run Rd
		** Map 42	SR 2970 - Ravens Bluff Ct

\* Charge to 2024CPT.07.04.20411  
\*\* Charge to 2024CPT.07.04.20791

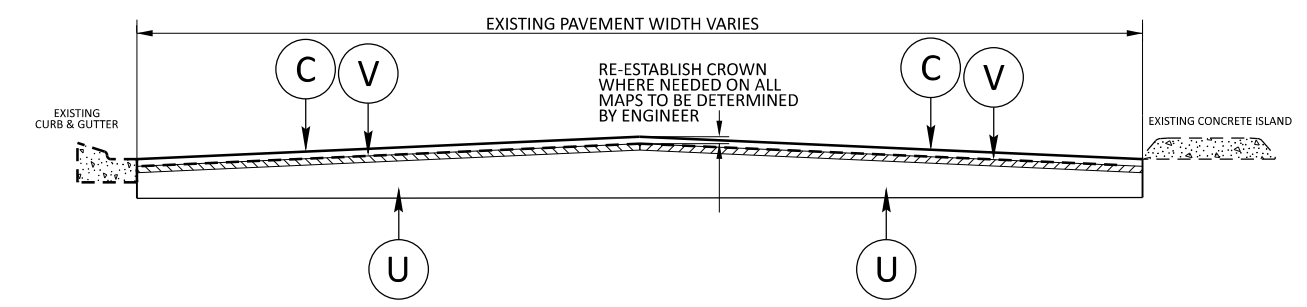

**TYPICAL SECTION NO. 4**

Map 8 SR 4951 - William Wallace Dr

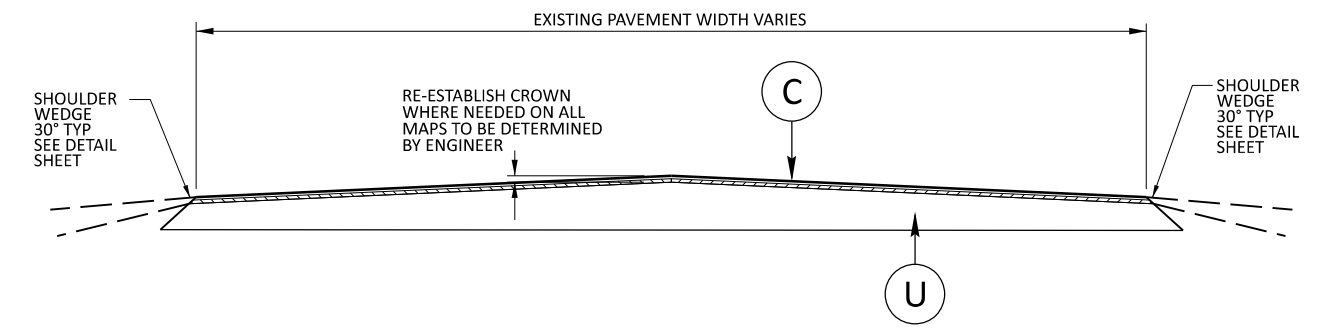

**TYPICAL SECTION NO. 5**

Map 7 SR 4952 - Loch Lomond Dr  
Map 39 SR 5517 - Rob Roy Drive

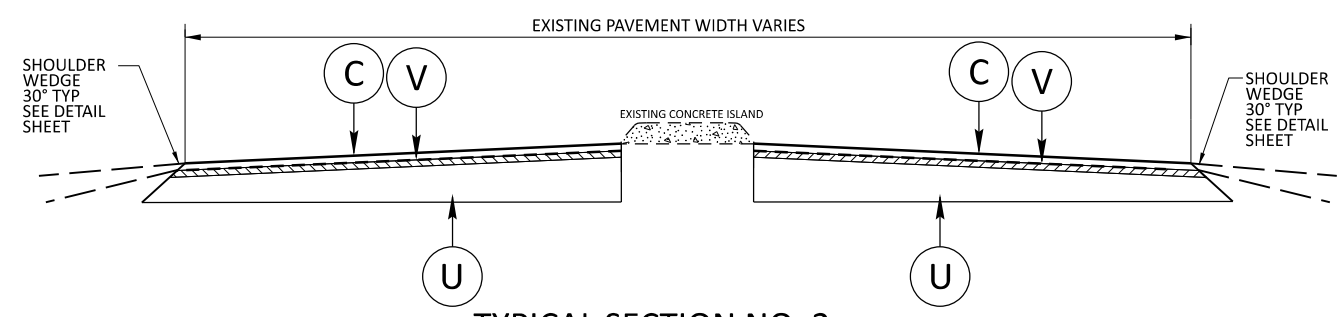

**TYPICAL SECTION NO. 2**

Map 3	SR 4950 - Lennox Woods Dr	Map 20	SR 5219 - Burfield Pl
Map 8	SR 4951 - William Wallace Dr		Mill & fill roughly 40 ft beyond island to avoid transitioning in driveway.

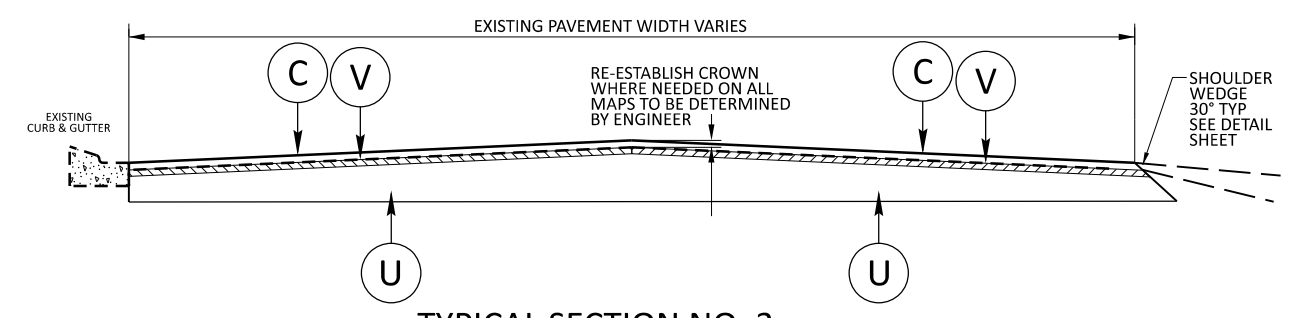

**TYPICAL SECTION NO. 3**

Map 8 SR 4951 - William Wallace Dr

**NOTE**

- For Maps 3, 8 and 20, perform Mill & Fill (Typicals 2, 3 and 4) on sections where there are Concrete Islands or Curbs present, otherwise utilize Mat Coat.
- For Maps 3, 8 and 20, Incidental Mill transitions between Mat Coat and Mill & Fill.

PAVEMENT SCHEDULE	
C	PROP. APPROX. 1 ½" ASPHALT CONCRETE SURFACE COURSE, TYPE S9.5B, TO BE APPLIED AT AN AVERAGE RATE OF 165 LBS PER SQ YD.
F	AST MAT COAT, #78M
U	EXISTING PAVEMENT
V	MILL ASPHALT PAVEMENT, 1 ½" DEPTH



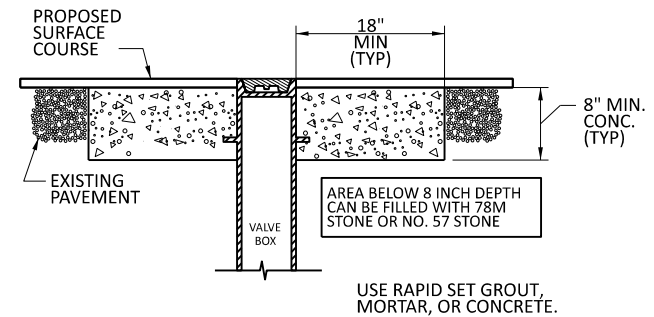

**STANDARD CONCRETE ENCASEMENT FOR VALVE CASTINGS IN PAVEMENT**

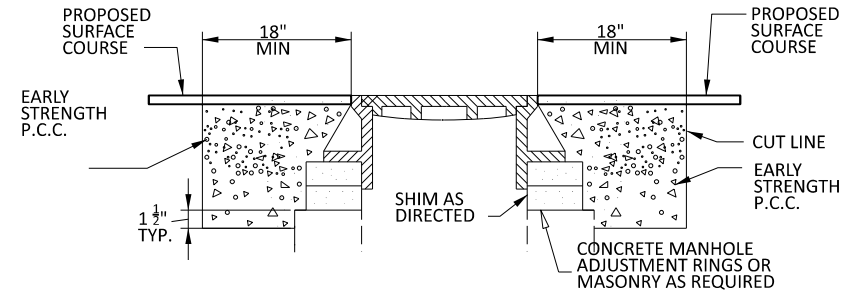

- NOTES:
1. MORTAR SHALL BE MIXED TO NCDOT SPECIFICATIONS.
  2. ALL FAULTY EXISTING BRICKWORK TO BE REMOVED AND REPLACED WITH NEW BRICK MASONRY.
  3. EXCAVATION FOR THE ADJUSTMENT SHALL BE SHEER CUT ON ALL SIDES.
  4. RAPID SET GROUT, MORTAR, OR CONCRETE SHALL BE USED CLASS B CONCRETE MAY BE USED WHEN ADJUSTMENTS ARE NOT IN THE TRAVEL LANE.

**STANDARD CONCRETE ENCASEMENT FOR MANHOLE CASTINGS IN PAVEMENT**

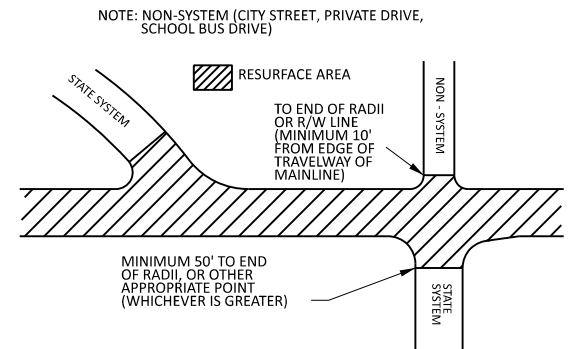

**PAVING DETAIL 1  
MAIN LINE IS BEING RESURFACED**

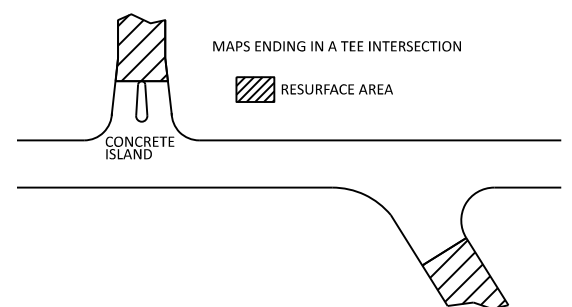

**PAVING DETAIL 2  
MAIN LINE NOT BEING RESURFACED**

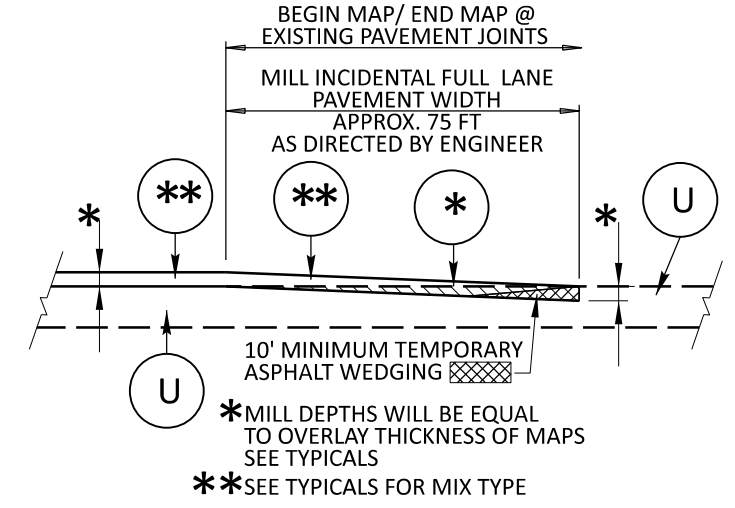

**INCIDENTAL MILLING AT TIE-IN DETAIL**

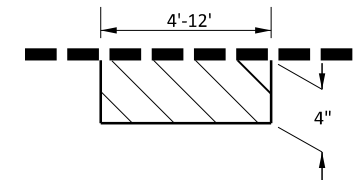

MILL FILL WITH INTERMEDIATE COURSE, TYPE I19.0C AT LOCATIONS AS DIRECTED BY THE ENGINEER.

**PATCHING EXISTING PAVEMENT DETAIL**

PAVEMENT SCHEDULE	
C	PROP. APPROX. 1 1/2" ASPHALT CONCRETE SURFACE COURSE, TYPE S9.5B, TO BE APPLIED AT AN AVERAGE RATE OF 165 LBS PER SQ YD.
F	AST MAT COAT, #78M
U	EXISTING PAVEMENT
V	MILL ASPHALT PAVEMENT, 1 1/2" DEPTH

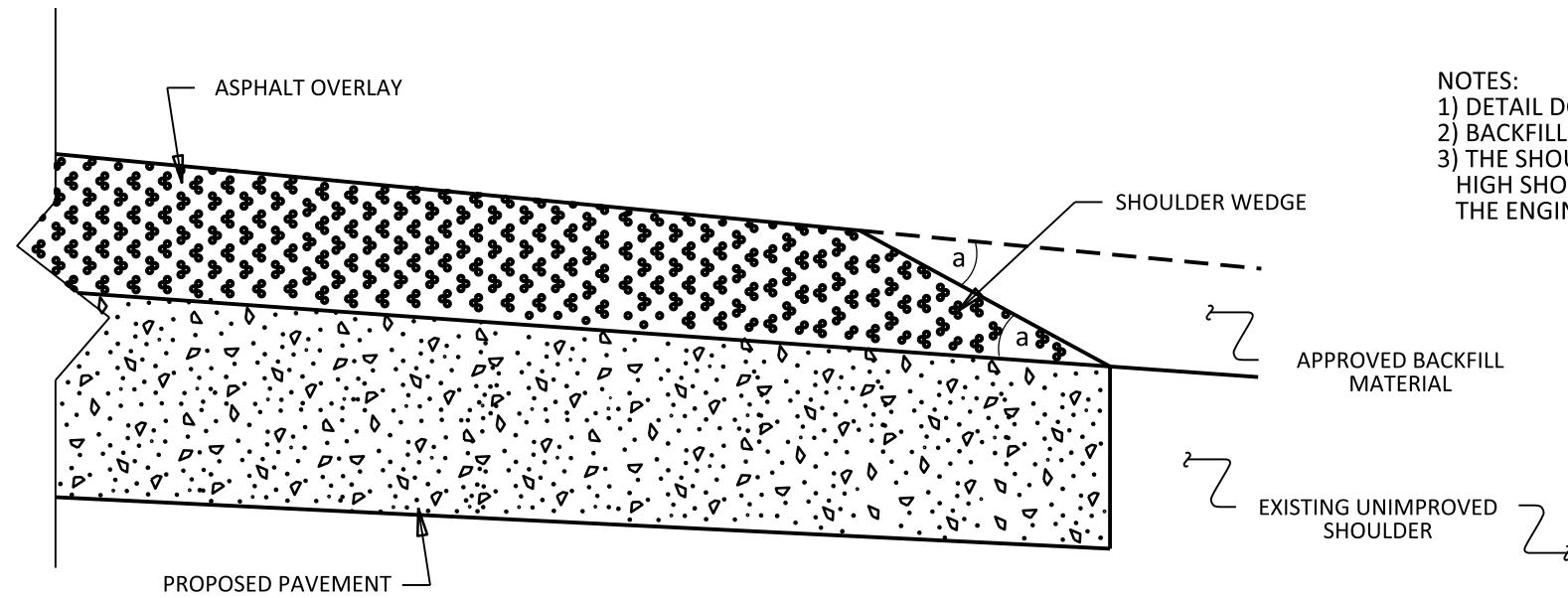

- NOTES:
- 1) DETAIL DOES NOT APPLY TO OGAFc AND ULTRA-THIN BONDED WEARING COURSE.
  - 2) BACKFILL SHOULDER WITH APPROVED MATERIAL.
  - 3) THE SHOULDER WEDGE DEVICE MAY BE DISENGAGED AT PAVED DRIVEWAYS AND SIDE STREETS, HIGH SHOULDERS, AND OTHER LOCATIONS NOT FEASIBLE TO CONSTRUCT AS DIRECTED BY THE ENGINEER.

### SHOULDER WEDGE DETAIL

(Resurfacing Projects w/ Widening or with Existing Paved Shoulder having no dropoffs)

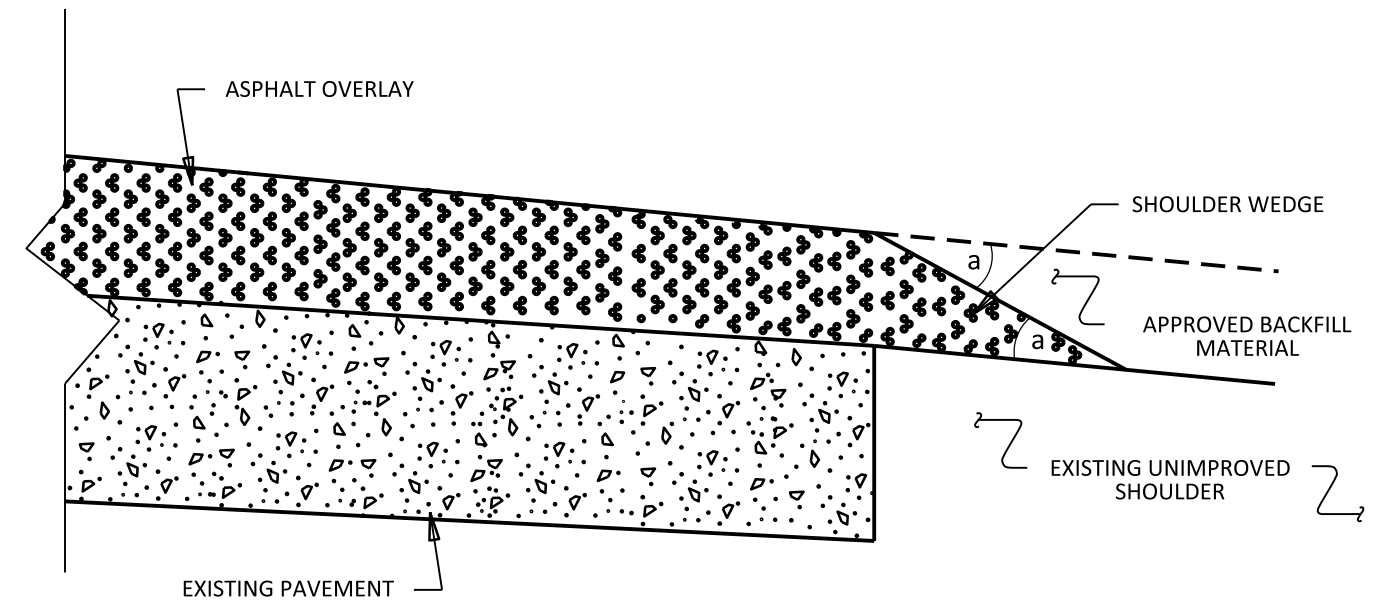

### SHOULDER WEDGE DETAIL

(Resurfacing Projects w/ NO Widening)

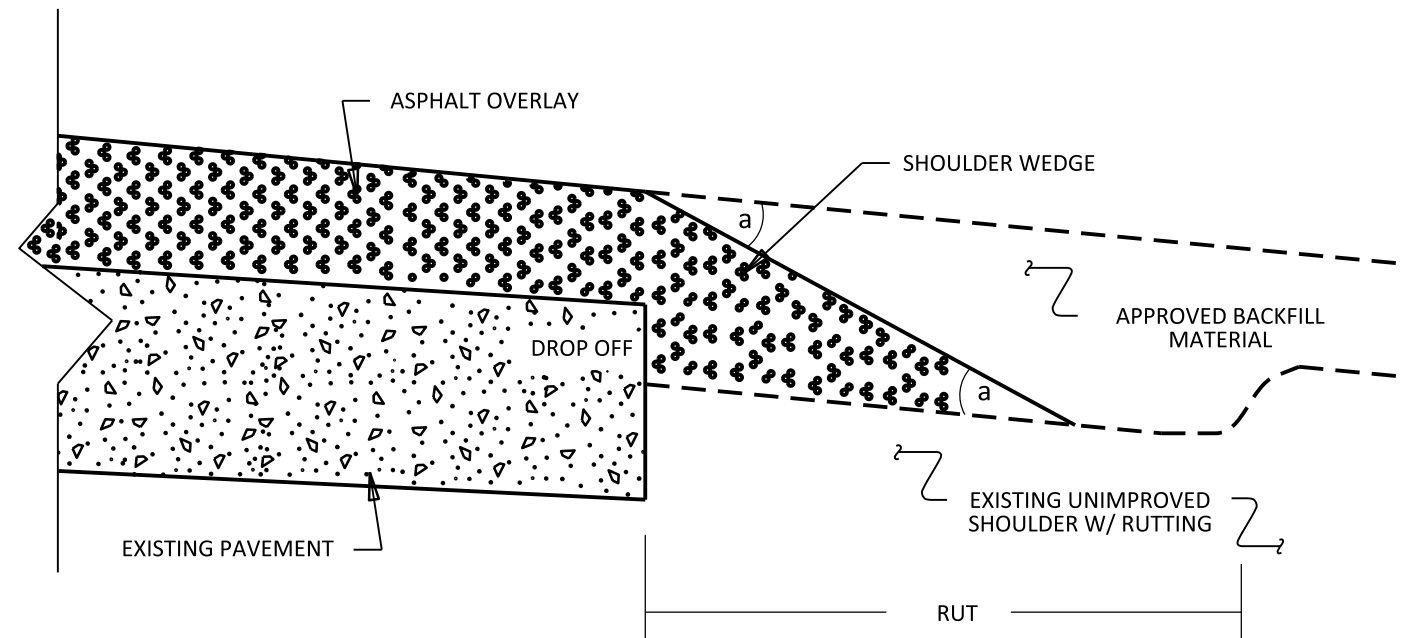

### SHOULDER WEDGE DETAIL

(Resurfacing Adjacent to Rutted Shoulder)

- SHOULDER WEDGE ANGLE = 30°

CONTRACT STANDARDS AND DEVELOPMENT UNIT Office 919-707-6950 FAX 919-250-4119			
<b>SHOULDER WEDGE DETAILS</b>			
ORIGINAL BY:	T.SPELL	DATE:	7-19-11
MODIFIED BY:		DATE:	10/16/12
CHECKED BY:		DATE:	
FILE SPEC.:	susr/details/stand/shoulderwedge/detail.dgn		

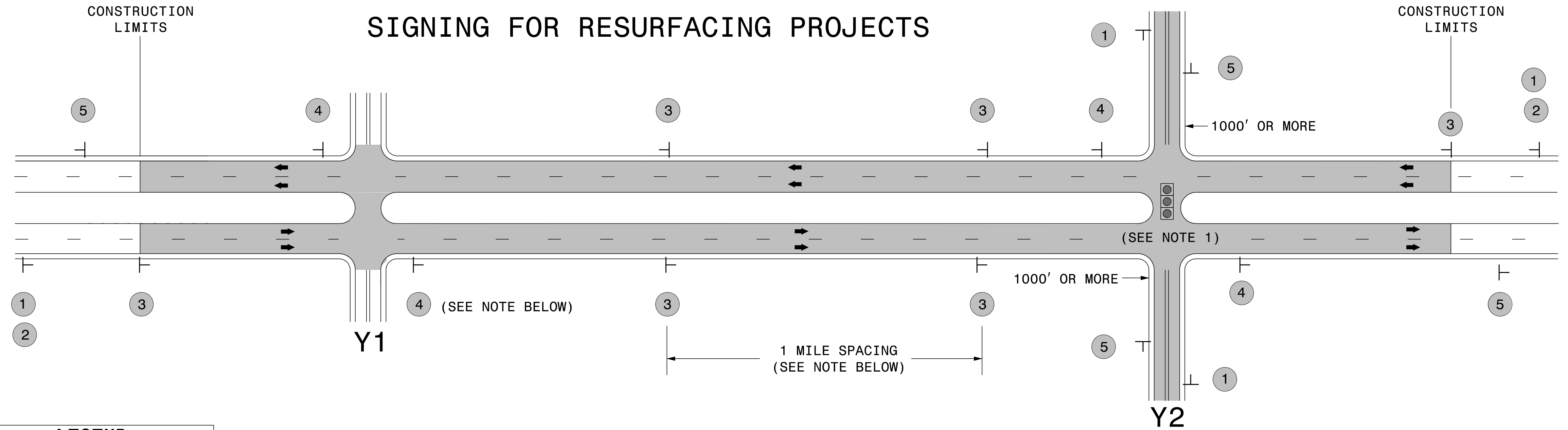

LEGEND	
┆	STATIONARY SIGN
←	DIRECTION OF TRAFFIC FLOW

### MAINLINE (-L-) SIGNING

### -Y- LINE SIGNING

SIGNING NOTES AND PLACEMENT PER DIRECTION	 	<p>PLACE 1000' PRIOR TO BEGINNING OF CONSTRUCTION LIMITS. ONLY USED ON -Y- LINES IF RESURFACING LIMITS EXTEND 1000' ALONG -Y- LINE.</p> <p>#2 SIGN ONLY USED WHEN RESURFACING LIMITS ARE 2 OR MORE MILES IN LENGTH. ROUND UP TO NEXT WHOLE NUMBER. (NO FRACTIONAL OR DECIMAL NUMBERS)</p>	<p>NO REQUIRED STATIONARY SIGNING FOR THE FOLLOWING -Y- LINE CONDITIONS:</p> <ol style="list-style-type: none"> <li>1) LESS THAN 1000' OF RESURFACING ALONG -Y- LINE</li> <li>2) SUBDIVISION ROADS</li> <li>3) DEAD END ROADS</li> </ol> <p>WHEN PAVING/CONSTRUCTION ACTIVITIES PROCEED ACROSS AN UNSIGNED -Y- LINE, ADVANCE WARNING PORTABLE SIGNS SHALL BE USED ALONG THE -Y- LINE AS SHOWN BELOW. REMOVE UPON COMPLETION OF WORK.</p> <div style="display: flex; justify-content: space-around; align-items: center;"> <div style="text-align: center;">   <small>W20-1 48" X 48"</small> </div> <div style="text-align: center;">   <small>W20-7 A 48" X 48"</small> </div> </div> <p>PLACED 500' IN ADVANCE OF FLAGGER. PLACED 250' IN ADVANCE OF FLAGGER.</p> <p>NOTES:</p> <ol style="list-style-type: none"> <li>1) MAY USE LAW ENFORCEMENT TO CONTROL TRAFFIC AT SIGNALIZED INTERSECTIONS AS DIRECTED BY THE ENGINEER. PROVIDE PORTABLE "ROAD WORK AHEAD" (W20-1) SIGNS 500' IN ADVANCE ALONG BOTH APPROACHES FROM THE SIDE STREETS WHEN PAVING PROCEEDS THROUGH THE INTERSECTION.</li> </ol>
		<p>PLACE INITIALLY AT THE CONSTRUCTION LIMITS AND SPACED 1 MILE APART THEREAFTER. IF NO -Y- LINES EXIST, PLACE 2ND SET 1/2 MILE FROM THE CONSTRUCTION LIMITS AND THEN SPACE 1 MILE THEREAFTER.</p>	
		<p>THESE ARE FOR -Y- LINES THAT ARE "THROUGH" ROADWAYS. DEAD END AND SUBDIVISION ROADS ARE NOT "THROUGH" ROADWAYS. INSTALL 500' +/- FROM EACH -Y- LINE APPROACH AS SHOWN ABOVE. FOR MULTIPLE -Y- LINES THAT ARE SEPARATED BY 0.25 MILES OR LESS, TREAT AS A SINGLE UNIT AND INSTALL WITHIN 500' OF EACH APPROACH. A MAXIMUM OF 2 SIGN SETS PER MILE. DO NOT INSTALL WHEN -Y- LINES ARE WITHIN 0.5 MILES FROM "END ROAD WORK" SIGN.</p>	
		<p>PLACE 500' FOLLOWING THE END OF CONSTRUCTION LIMITS.</p>	

3/23/2015  
C:\Users\rmgarrrett\Downloads\Resurfacing\_AdvWarn\_Lr-Su\_Shldr.dgn  
User:rmgarrrett

**RESURFACING  
ADVANCE WARNING SIGNS  
FOR RURAL AND SUBURBAN  
MULTI-LANE ROADWAYS  
W/ SHOULDER SECTIONS**

PROJECT NO.	SHEET NO.	TOTAL NO.
2024CPT.07.04.20411, 2024CPT.07.04.20791	11	12

## SUMMARY OF QUANTITIES

PROJECT NO	COUNTY	MAP NO	ROUTE	DESCRIPTION	TYP NO	LANES	LANE TYPE	FINAL SURFACE TESTING REQUIRED	WARM MIX ASPHALT REQUIRED	LENGTH	WIDTH	1220000000-E	1297000000-E	1330000000-E	1519000000-E	1575000000-E	1704000000-E	1775000000-E	1838000000-E	2845000000-N	4413000000-E	4457000000-N			
												INCIDENTAL STONE	MILLING ASPHALT PAVEMENT, DEPTH (1 1/2")	INCIDENTAL MILLING	ASPHALT CONC SURFACE COURSE, TYPE S9.5B	ASPHALT BINDER FOR PLANT MIX	PATCHING EXISTING PAVEMENT	ASPHALT SURFACE TREATMENT, MAT COAT, #78M STONE	EMULSION FOR ASPHALT SURFACE TREATMENT	ADJUSTMENT OF METER BOXES OR VALVE BOXES	WORK ZONE ADVANCE/GENERAL WARNING SIGNING	TEMPORARY TRAFFIC CONTROL			
												MI	FT	TONS	SY	SY	TONS	TON	TONS	SY	GAL	EA	SF	LS	
2024CPT.07.04.20411	Guilford	1	SR 4900 - FOX CROSSING RD	FROM SR 2687 - RIVER RUN RD TO CUL DE SAC	1	2		NO	NO	0.106	21												0.95		
<b>TOTAL FOR MAP NO. 1</b>												<b>0.106</b>		<b>8</b>			<b>154</b>	<b>10</b>		<b>1,685</b>	<b>556</b>		<b>12</b>		
2024CPT.07.04.20411	Guilford	2	SR 2687 - RIVER RUN RD	FROM SR 2500 - SPEARMAN RD TO RCL	1	2		NO	NO	0.652	20			171	736	49	30	7,574	2,499				74		
<b>TOTAL FOR MAP NO. 2</b>												<b>0.652</b>		<b>23</b>		<b>171</b>	<b>736</b>	<b>49</b>	<b>30</b>	<b>7,574</b>	<b>2,499</b>		<b>74</b>		
2024CPT.07.04.20411	Guilford	3	SR 4950 - LENNOX WOODS DR	FROM SR 2310 - CUMMINGS DAIRY RD TO SR 4951 - WILLIAM WALLACE DR	1,2	2		NO	NO	0.088	21			427	646	136	9		1,069	353			10		
<b>TOTAL FOR MAP NO. 3</b>												<b>0.088</b>				<b>427</b>	<b>646</b>	<b>136</b>	<b>9</b>		<b>1,069</b>	<b>353</b>		<b>10</b>	
2024CPT.07.04.20411	Guilford	4	SR 4955 - BETHAN DR	FROM SR 2310 - CUMMINGS DAIRY RD TO SR 4955 - BETHAN DR	1	2		NO	NO	0.663	21			179	778	51	4	8,098	2,672				75		
<b>TOTAL FOR MAP NO. 4</b>												<b>0.663</b>				<b>179</b>	<b>778</b>	<b>51</b>	<b>4</b>	<b>8,098</b>	<b>2,672</b>		<b>75</b>		
2024CPT.07.04.20411	Guilford	5	SR 4953 - IPSWICH CT	FROM SR 4952 - LOCH LOMOND DR TO CUL-DE-SAC	1	2		NO	NO	0.112	20				156	10			1,715	566			13		
<b>TOTAL FOR MAP NO. 5</b>												<b>0.112</b>					<b>156</b>	<b>10</b>		<b>1,715</b>	<b>566</b>		<b>13</b>		
2024CPT.07.04.20411	Guilford	6	SR 4954 - KINTAIL CT	FROM SR 4951 - WILLIAM WALLACE DR TO CUL-DE-SAC	1	2		NO	NO	0.13	21				208	14			2,278	752			15		
<b>TOTAL FOR MAP NO. 6</b>												<b>0.13</b>					<b>208</b>	<b>14</b>		<b>2,278</b>	<b>752</b>		<b>15</b>		
2024CPT.07.04.20411	Guilford	7	SR 4952 - LOCH LOMOND DR	FROM SR 4951 - WILLIAM WALLACE DR TO SR 2390 - MABE-MARSHALL RD	1,5	2		NO	NO	0.378	21				473	31			1,318	435	2		45		
<b>TOTAL FOR MAP NO. 7</b>												<b>0.378</b>					<b>473</b>	<b>31</b>		<b>1,318</b>	<b>435</b>	<b>2</b>	<b>45</b>		
2024CPT.07.04.20411	Guilford	8	SR 4951 - WILLIAM WALLACE DR	FROM SR 4955 - BETHAN DR TO END MAINT	1,2,3,4	2		NO	NO	0.587	20			1,089	404	691	45		5,973	1,971			66		
<b>TOTAL FOR MAP NO. 8</b>												<b>0.587</b>				<b>1,089</b>	<b>404</b>	<b>691</b>	<b>45</b>		<b>5,973</b>	<b>1,971</b>		<b>66</b>	
2024CPT.07.04.20411	Guilford	9	SR 4965 - ROYAL STEWART CT	FROM SR 4955 - BETHAN DR TO CUL-DE-SAC	1	2		NO	NO	0.027	21				80	5			882	291			4		
<b>TOTAL FOR MAP NO. 9</b>												<b>0.027</b>					<b>80</b>	<b>5</b>		<b>882</b>	<b>291</b>		<b>4</b>		
2024CPT.07.04.20411	Guilford	10	SR 2310 - CUMMINGS DAIRY RD	FROM SR 1002 - SCALESVILLE RD TO END MAINT	1	2		NO	NO	0.691	21			175	818	53			8,272	2,730			78		
<b>TOTAL FOR MAP NO. 10</b>												<b>0.691</b>				<b>175</b>	<b>818</b>	<b>53</b>		<b>8,272</b>	<b>2,730</b>		<b>78</b>		
2024CPT.07.04.20411	Guilford	11	SR 2688 - SPENCERS GROVE RD	FROM SR 2504 - FAIRGROVE CHURCH RD TO CUL-DE-SAC	1	2		NO	NO	0.23	21			188	302	20	8	3,309	1,092				26		
<b>TOTAL FOR MAP NO. 11</b>												<b>0.23</b>				<b>188</b>	<b>302</b>	<b>20</b>	<b>8</b>	<b>3,309</b>	<b>1,092</b>		<b>26</b>		
2024CPT.07.04.20411	Guilford	12	SR 4767 - MITCHELL WOOD DR	FROM SR 2688 - SPENCERS GROVE RD TO SR 4772 - BUSICKWOOD DR	1	2		NO	NO	0.426	21				486	32	16	5,087	1,679				48		
<b>TOTAL FOR MAP NO. 12</b>												<b>0.426</b>					<b>486</b>	<b>32</b>	<b>16</b>	<b>5,087</b>	<b>1,679</b>		<b>48</b>		
2024CPT.07.04.20411	Guilford	13	SR 4772 - BUSICKWOOD DR	FROM SR 5225 - WALBROOK TR TO CUL-DE-SAC	1	2		NO	NO	0.2	21				253	16			2,773	915			23		
<b>TOTAL FOR MAP NO. 13</b>												<b>0.2</b>					<b>253</b>	<b>16</b>		<b>2,773</b>	<b>915</b>		<b>23</b>		
2024CPT.07.04.20411	Guilford	14	SR 5225 - WALBROOK TR	FROM CUL-DE-SAC TO CUL-DE-SAC	1	2		NO	NO	0.328	21				428	28			4,691	1,548			37		
<b>TOTAL FOR MAP NO. 14</b>												<b>0.328</b>					<b>428</b>	<b>28</b>		<b>4,691</b>	<b>1,548</b>		<b>37</b>		
2024CPT.07.04.20411	Guilford	15	SR 5220 - GARRICK TRC	FROM DEAD END TO CUL-DE-SAC	1	2		NO	NO	0.32	20				387	25			3,795	1,252			36		
<b>TOTAL FOR MAP NO. 15</b>												<b>0.32</b>					<b>387</b>	<b>25</b>		<b>3,795</b>	<b>1,252</b>		<b>36</b>		
2024CPT.07.04.20411	Guilford	16	SR 5237 - EXMOOR TRC	FROM SR 5220 - GARRICK TRC TO PVMT JOINT	1	2		NO	NO	0.043	21			175	54	4			432	142			5		
<b>TOTAL FOR MAP NO. 16</b>												<b>0.043</b>				<b>175</b>	<b>54</b>	<b>4</b>		<b>432</b>	<b>142</b>		<b>5</b>		
2024CPT.07.04.20411	Guilford	17	SR 5222 - DORWOOD DR	FROM SR 5223 - ALDGATE WAY TO END OF MAINT	1	2		NO	NO	0.34	21				391	25			3,978	1,313			39		
<b>TOTAL FOR MAP NO. 17</b>												<b>0.34</b>					<b>391</b>	<b>25</b>		<b>3,978</b>	<b>1,313</b>		<b>39</b>		
2024CPT.07.04.20411	Guilford	18	SR 5221 - CRIPPLEGATE TRL	FROM END OF MAINT TO CUL-DE-SAC	1	2		NO	NO	0.646	21				775	50			7,739	2,554			73		
<b>TOTAL FOR MAP NO. 18</b>												<b>0.646</b>					<b>775</b>	<b>50</b>		<b>7,739</b>	<b>2,554</b>		<b>73</b>		
2024CPT.07.04.20411	Guilford	19	SR 5223 - ALDGATE WAY	FROM SR 5224 - NEWGATE TRC TO SR 5221 - CRIPPLEGATE TRL	1	2		NO	NO	0.185	21				213	14			2,193	724			21		
<b>TOTAL FOR MAP NO. 19</b>												<b>0.185</b>					<b>213</b>	<b>14</b>		<b>2,193</b>	<b>724</b>		<b>21</b>		
2024CPT.07.04.20411	Guilford	20	SR 5219 - BURFIELD PL	FROM SR 2502 - BEVILL OAKS RD TO SR 5220 - GARRICK TRC	1,2	2		NO	NO	0.056	26			353	233	91	6	644	212				7		
<b>TOTAL FOR MAP NO. 20</b>												<b>0.056</b>				<b>353</b>	<b>233</b>	<b>91</b>	<b>6</b>	<b>644</b>	<b>212</b>		<b>7</b>		
2024CPT.07.04.20411	Guilford	21	SR 2502 - BEVILL OAKS RD	FROM SR 2504 - FAIRGROVE CHURCH RD TO SR 5221 - CRIPPLEGATE TRL	1	2		NO	NO	0.436	21				492	32			5,303	1,750			49		
<b>TOTAL FOR MAP NO. 21</b>												<b>0.436</b>					<b>492</b>	<b>32</b>		<b>5,303</b>	<b>1,750</b>		<b>49</b>		
2024CPT.07.04.20411	Guilford	22	SR 5224 - NEWGATE TRC	FROM SR 5221 - CRIPPLEGATE TRL TO END OF MAINT	1	2		NO	NO	0.295	21				367	24			3,784	1,249			34		
<b>TOTAL FOR MAP NO. 22</b>												<b>0.295</b>					<b>367</b>	<b>24</b>		<b>3,784</b>	<b>1,249</b>		<b>34</b>		

Map 22 charge to 2024CPT.07.04.20411  
Map 37, charge to 2024CPT.07.04.20411  
Map 41, 42, charge to 2024CPT.07.04.20791

PROJECT NO.	SHEET NO.	TOTAL NO.
2024CPT.07.04.20411, 2024CPT.07.04.20791	12	12

### SUMMARY OF QUANTITIES

PROJECT NO	COUNTY	MAP NO	ROUTE	DESCRIPTION	TYP NO	LANES	LANE TYPE	FINAL SURFACE TESTING REQUIRED	WARM MIX ASPHALT REQUIRED	LENGTH	WIDTH	1220000000-E	1297000000-E	1330000000-E	1519000000-E	1575000000-E	1704000000-E	1775000000-E	1838000000-E	2845000000-N	4413000000-E	4457000000-N				
												INCIDENTAL STONE	MILLING ASPHALT PAVEMENT, DEPTH (1 1/2")	INCIDENTAL MILLING	ASPHALT CONC SURFACE COURSE, TYPE S9.5B	ASPHALT BINDER FOR PLANT MIX	PATCHING EXISTING PAVEMENT	ASPHALT SURFACE TREATMENT, MAT COAT, #78M STONE	EMULSION FOR ASPHALT SURFACE TREATMENT	ADJUSTMENT OF METER BOXES OR VALVE BOXES	WORK ZONE ADVANCE/GENERAL WARNING SIGNING	TEMPORARY TRAFFIC CONTROL				
											MI	FT	TONS	SY	SY	TONS	TON	TONS	SY	GAL	EA	SF	LS			
2024CPT.07.04.20411	Guilford	23	SR 2699 - NORTHBAY DR	FROM SR 2523 - YANCEYVILLE RD TO SR 2630 - DOGGETT RD	1	2		NO	NO	0.955	20			3		342		1,075	71	22	10,933	3,608		108		
<b>TOTAL FOR MAP NO. 23</b>											<b>0.955</b>		<b>3</b>		<b>342</b>		<b>1,075</b>	<b>71</b>	<b>22</b>	<b>10,933</b>	<b>3,608</b>		<b>108</b>			
2024CPT.07.04.20411	Guilford	24	SR 5200 - WICKLOW DR	FROM SR 2699 - NORTHBAY DR TO SR 2699 - NORTHBAY DR	1	2		NO	NO	0.286	21							322	21		3,523	1,163		33		
<b>TOTAL FOR MAP NO. 24</b>											<b>0.286</b>						<b>322</b>	<b>21</b>		<b>3,523</b>	<b>1,163</b>		<b>33</b>			
2024CPT.07.04.20411	Guilford	25	SR 5201 - LISMORE DR	FROM SR 2699 - NORTHBAY DR TO CUL-DE-SAC	1	2		NO	NO	0.439	20			3				521	34		5,706	1,883		50		
<b>TOTAL FOR MAP NO. 25</b>											<b>0.439</b>		<b>3</b>				<b>521</b>	<b>34</b>		<b>5,706</b>	<b>1,883</b>		<b>50</b>			
2024CPT.07.04.20411	Guilford	26	SR 5210 - BANTRY CT	FROM SR 2699 - NORTHBAY DR TO CUL-DE-SAC	1	2		NO	NO	0.07	21							110	7		1,205	398		8		
<b>TOTAL FOR MAP NO. 26</b>											<b>0.07</b>						<b>110</b>	<b>7</b>		<b>1,205</b>	<b>398</b>		<b>8</b>			
2024CPT.07.04.20411	Guilford	27	SR 4919 - JAMES DOAK PKWY	FROM SR 2329 - SPENCER-DIXON RD TO DEAD END	1	2		NO	NO	0.271	24					217		368	25	28	3,588	1,184		31		
<b>TOTAL FOR MAP NO. 27</b>											<b>0.271</b>					<b>217</b>		<b>368</b>	<b>25</b>	<b>28</b>	<b>3,588</b>	<b>1,184</b>		<b>31</b>		
2024CPT.07.04.20411	Guilford	28	SR 4921 - CLOPTON DR	FROM SR 4919 - JAMES DOAK PKWY TO DEAD END	1	2		NO	NO	0.294	20							330	22	4	3,439	1,135		33		
<b>TOTAL FOR MAP NO. 28</b>											<b>0.294</b>						<b>330</b>	<b>22</b>	<b>4</b>	<b>3,439</b>	<b>1,135</b>		<b>33</b>			
2024CPT.07.04.20411	Guilford	29	SR 4922 - FOSSEWAY DR	FROM SR 4921 - CLOPTON DR TO DEAD END	1	2		NO	NO	0.245	20							277	18	8	2,859	943		28		
<b>TOTAL FOR MAP NO. 29</b>											<b>0.245</b>						<b>277</b>	<b>18</b>	<b>8</b>	<b>2,859</b>	<b>943</b>		<b>28</b>			
2024CPT.07.04.20411	Guilford	30	SR 4923 - BRIXHAM DR	FROM SR 4919 - JAMES DOAK PKWY TO SR 4922 - FOSSEWAY DR	1	2		NO	NO	0.136	20							150	10		1,640	541		16		
<b>TOTAL FOR MAP NO. 30</b>											<b>0.136</b>						<b>150</b>	<b>10</b>		<b>1,640</b>	<b>541</b>		<b>16</b>			
2024CPT.07.04.20411	Guilford	31	SR 4920 - COLWYN CT	FROM SR 4919 - JAMES DOAK PKWY TO CUL-DE-SAC	1	2		NO	NO	0.128	20							168	11	8	1,846	609		15		
<b>TOTAL FOR MAP NO. 31</b>											<b>0.128</b>						<b>168</b>	<b>11</b>	<b>8</b>	<b>1,846</b>	<b>609</b>		<b>15</b>			
2024CPT.07.04.20411	Guilford	32	SR 2521 - FAIRHAVEN RD	FROM SR 2520 - BURTON FARM RD TO CUL-DE-SAC	1	2		NO	NO	0.619	21			28		175		741	49	8	7,719	2,547		70		
<b>TOTAL FOR MAP NO. 32</b>											<b>0.619</b>		<b>28</b>		<b>175</b>		<b>741</b>	<b>49</b>	<b>8</b>	<b>7,719</b>	<b>2,547</b>		<b>70</b>			
2024CPT.07.04.20411	Guilford	33	SR 4902 - FOXHAVEN DR	FROM SR 2520 - BURTON FARM RD TO CUL-DE-SAC	1	2		NO	NO	0.488	21					371		568	37	6	5,828	1,923		55		
<b>TOTAL FOR MAP NO. 33</b>											<b>0.488</b>				<b>371</b>		<b>568</b>	<b>37</b>	<b>6</b>	<b>5,828</b>	<b>1,923</b>		<b>55</b>			
2024CPT.07.04.20411	Guilford	34	SR 4905 - FOXHAVEN CT	FROM SR 4902 - FOXHAVEN DR TO CUL-DE-SAC	1	2		NO	NO	0.128	20			3				172	12	8	1,887	623		15		
<b>TOTAL FOR MAP NO. 34</b>											<b>0.128</b>		<b>3</b>				<b>172</b>	<b>12</b>	<b>8</b>	<b>1,887</b>	<b>623</b>		<b>15</b>			
2024CPT.07.04.20411	Guilford	35	SR 4904 - TALLY HO CT	FROM SR 4903 - FOXDALE DR TO CUL-DE-SAC	1	2		NO	NO	0.071	21							117	8		1,280	423		8		
<b>TOTAL FOR MAP NO. 35</b>											<b>0.071</b>						<b>117</b>	<b>8</b>		<b>1,280</b>	<b>423</b>		<b>8</b>			
2024CPT.07.04.20411	Guilford	36	SR 4903 - FOXDALE DR	FROM SR 4902 - FOXHAVEN DR TO DEAD END	1	2		NO	NO	0.332	21							380	25		3,991	1,317		38		
<b>TOTAL FOR MAP NO. 36</b>											<b>0.332</b>						<b>380</b>	<b>25</b>		<b>3,991</b>	<b>1,317</b>		<b>38</b>			
2024CPT.07.04.20411	Guilford	37	SR 5236 - BISHOPSGATE WAY	FROM SR 5224 - NEWGATE TRC TO SR 5221 CRIPPLEGATE TRL	1	2		NO	NO	0.136	21							153	10		1,680	554		16		
<b>TOTAL FOR MAP NO. 37</b>											<b>0.136</b>						<b>153</b>	<b>10</b>		<b>1,680</b>	<b>554</b>		<b>16</b>			
2024CPT.07.04.20411	Guilford	38	SR 5519- CAITHNESS COURT	FROM SR 4952 - LOCH LOMOND DR TO CUL-DE-SAC	1	2		NO	NO	0.105	21			8				172	11		1,881	621		12		
<b>TOTAL FOR MAP NO. 38</b>											<b>0.105</b>		<b>8</b>				<b>172</b>	<b>11</b>		<b>1,881</b>	<b>621</b>		<b>12</b>			
2024CPT.07.04.20411	Guilford	39	SR 5517 - ROB ROY DR	FROM SR 4952 - LOCH LOMOND DR TO DEAD END	5	2		NO	NO	0.327	20							380	25					39		
<b>TOTAL FOR MAP NO. 39</b>											<b>0.327</b>						<b>380</b>	<b>25</b>					<b>39</b>			
2024CPT.07.04.20411	Guilford	40	SR 5518 - ROB ROY COURT	FROM SR 5517 - ROB ROY DR TO CUL-DE-SAC	1	2		NO	NO	0.028	21							83	5		912	301		4		
<b>TOTAL FOR MAP NO. 40</b>											<b>0.028</b>						<b>83</b>	<b>5</b>		<b>912</b>	<b>301</b>		<b>4</b>			
<b>TOTAL FOR PROJ NO. 2024CPT.07.04.20411</b>											<b>11.997</b>		<b>194</b>		<b>1,869</b>		<b>3,276</b>		<b>14,556</b>	<b>954</b>	<b>150</b>	<b>142,509</b>	<b>47,028</b>	<b>2</b>	<b>1,369</b>	<b>0.95</b>
2024CPT.07.04.20791	Rockingham	41	SR 2951 - RIVER RUN RD	FROM GUILFORD CO LINE TO CUL-DE-SAC	1	2		NO	NO	0.186	20			13				238	15		2,454	810		21		
<b>TOTAL FOR MAP NO. 41</b>											<b>0.186</b>		<b>13</b>				<b>238</b>	<b>15</b>		<b>2,454</b>	<b>810</b>		<b>21</b>			
2024CPT.07.04.20791	Rockingham	42	SR 2970 - RAVENS BLUFF CT	FROM SR 2951 - RIVER RUN RD TO CUL-DE-SAC	1	2		NO	NO	0.069	20			8				105	7		1,154	381		8		
<b>TOTAL FOR MAP NO. 42</b>											<b>0.069</b>		<b>8</b>				<b>105</b>	<b>7</b>		<b>1,154</b>	<b>381</b>		<b>8</b>			
<b>TOTAL FOR PROJ NO. 2024CPT.07.04.20791</b>											<b>0.255</b>		<b>21</b>				<b>343</b>	<b>22</b>		<b>3,608</b>	<b>1,191</b>		<b>29</b>	<b>0.05</b>		
<b>GRAND TOTAL</b>											<b>12.252</b>		<b>215</b>		<b>1,869</b>		<b>3,276</b>		<b>14,899</b>	<b>976</b>	<b>150</b>	<b>146,117</b>	<b>48,219</b>	<b>2</b>	<b>1,398</b>	<b>1.00</b>

Map 22 charge to 2024CPT.07.04.20411  
Map 37, charge to 2024CPT.07.04.20411  
Map 41, 42, charge to 2024CPT.07.04.20791